

Chickpea and Faba bean Seed Applied Pesticide Compatibility Information

Nodulator® for Chickpea and Faba bean

Other		Nodulator Chickpea Peat	Nodulator Chickpea SCG	Nodulator Faba Bean Peat
Non-pesticide treated seed		1 day	Fully compatible	1 day
Apron® Advance	Tank-mix* time on seed	Not recommended	Fully compatible	Not recommended
	Wet sequential	4 hours	Fully compatible	Not recommended
	Dry sequential	4 hours	Fully compatible	1 day
Apron FL	Tank-mix* time on seed		Fully compatible	
	Wet sequential	1 day	Fully compatible	
	Dry sequential	1 day	Fully compatible	
Apron XL	Tank-mix* time on seed		Fully compatible	
	Wet sequential		Fully compatible	
	Dry sequential		Fully compatible	
Apron XL + Maxim®	Tank-mix* time on seed		Fully compatible	
	Wet sequential		Fully compatible	
	Dry sequential		Fully compatible	
ApronMaxx® RTA	Tank-mix* time on seed		Fully compatible	
	Wet sequential	6 hours	Fully compatible	2 hours
	Dry sequential	2 hours	Fully compatible	4 hours
Crown®	Tank-mix* time on seed		Fully compatible	
	Wet sequential	24 hours	Fully compatible	
	Dry sequential	24 hours	Fully compatible	
CruiserMaxx® Pulses (Cruiser® 5FS + ApronMaxx RTA)	Tank-mix* time on seed		Fully compatible	
	Wet sequential	24 hours	Fully compatible	6 hours
	Dry sequential	6 hours	Fully compatible	6 hours
Insure® Pulse	Tank-mix* time on seed		Fully compatible	
	Wet sequential	24 hours	Fully compatible	Not recommended
	Dry sequential	6 hours	Fully compatible	Not recommended
Thiram 75WP	Tank-mix* time on seed		Fully compatible	
	Wet sequential		Fully compatible	
	Dry sequential		Fully compatible	
Trilex® AL	Tank-mix* time on seed		Fully compatible	
	Wet sequential	1 day	Fully compatible	4 hours
	Dry sequential	12 hours	Fully compatible	2 hours
Trilex EverGo®	Tank-mix* time on seed	Not recommended	Fully compatible	
	Wet sequential	2 hours	Fully compatible	2 hours
	Dry sequential	2 hours	Fully compatible	4 hours
Vitaflo® 280	Tank-mix* time on seed		Fully compatible	
	Wet sequential		Fully compatible	
	Dry sequential		Fully compatible	
IPCO Vitaflo Seed Fungicide	Tank-mix* time on seed		Fully compatible	
	Wet sequential		Fully compatible	
	Dry sequential		Fully compatible	
Viterrra Vitaflo Fungicide	Tank-mix* time on seed		Fully compatible	
	Wet sequential		Fully compatible	
	Dry sequential		Fully compatible	

 Not applicable or not available

* These on-seed shelf life recommendations are based on a maximum 4 hour tank-mix period.

This data is correct at the time of distribution. Please check with your dealer for updates. **Updated:** 2016

Application methods for inoculants with seed treatments

BASF inoculants are compatible with many registered seed treatments. Use the registered labels or compatibility charts for individual products plus the following descriptions for information on application methods.

TANK MIX

The inoculant is mixed with the seed treatment in a single tank and applied as one solution or suspension using the same applicator. The inoculant and seed treatment can be tank mixed for a period of time before application to the seed.



SIMULTANEOUS (WET SEQUENTIAL)

The inoculant and seed treatment are applied at the same time, from separate tanks. They must be applied by separate applicators to be defined as a simultaneous or wet sequential application.

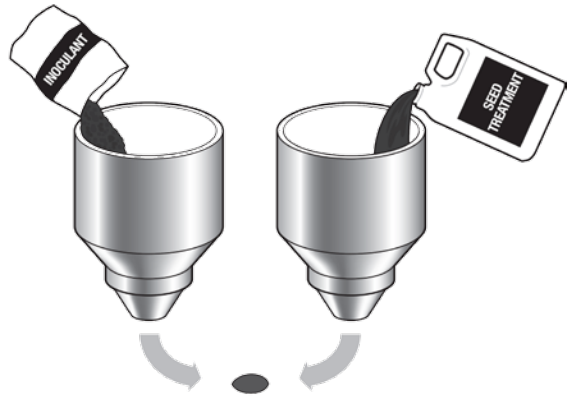

DRY SEQUENTIAL

One product is applied first and allowed to dry, before the second product is applied. This can be a seed treatment followed by an inoculant or an inoculant followed by a seed treatment. Drying time will vary based on formulation, relative air humidity, and other factors. A minimum 30 minutes is typical but it may take up to a day.

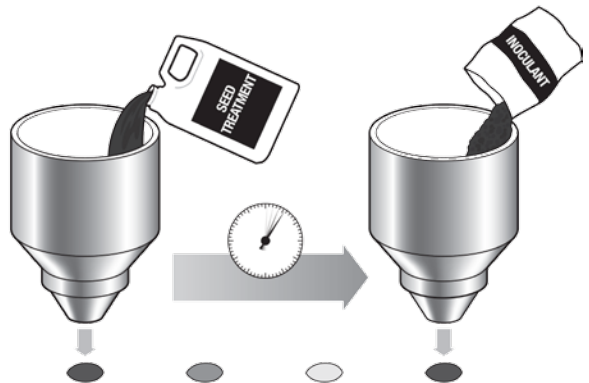

For more information call **AgSolutions**® Customer Care at 1-877-371-BASF (2273), speak to your BASF Sales Representative or visit agsolutions.ca.

Always read and follow label directions.

AgSolutions is a registered trade-mark of BASF Corporation; NODULATOR is a registered trade-mark of Becker Underwood Canada Inc.; INSURE is a registered trade-mark of BASF SE; all used with permission by BASF Canada Inc. INSURE PULSE fungicide seed treatment should be used in a preventative disease control program. © 2016 BASF Canada Inc.

Apron, ApronMaxx, Cruiser, Maxim and CruiserMaxx are registered trade-marks of Syngenta Participations AG; Trilex is a registered trade-mark of Bayer CropScience LP; Evergol is a registered trade-mark of Bayer Intellectual Property GmbH.; Crown, and Vitaflo are registered trade-marks of Chemtura Canada Co./Cie. All other trade-marks are property of their respective owners.